

# ONIS VISA Zeus Dry Prime

**Model: MTZ.V175.SS**

## MODEL: Dewatering



ALL PICTURES SHOWN ARE FOR ILLUSTRATION PURPOSE ONLY

## MAIN DATA

Max. flow	<b>1589 m<sup>3</sup>/hour</b>
Max. Max head	<b>25 mwc</b>
Solids handling	<b>95 mm</b>
Suction connection	<b>DN300 PN10</b>
Delivery connection	<b>ANSI 12"</b>
Fuel tank	<b>850 l.</b>

## DIMENSIONS AND WEIGHT

Width	2086 mm
Length	4300 mm
Height	2497 mm
Weight	4400 Kg (approx)

The **Zeus Dry Prime** range delivers fast dewatering solutions to sites where a power source is not available. Using a Pioneer pump featuring a 100% mechanical priming system, the Zeus Dry Prime motorpumps quickly prime and reprime, even from dry conditions.

## PUMP



Brand	Pioneer
Model	PP1212S17T E0 311
Pump casing:	65-42-12 ductile iron with 280 BHN hardness
Enclosed impeller:	CA6NM Self-hardening Stainless Steel with 13% chromium with 360BHN hardness
Pump shaft:	1144 Stress Proof Steel Chromed
Bearings:	Dual angular contact drive end bearings
Priming system:	Mechanically Driven Diaphragm Style vacuum pump
Air removal capab.:	1 x 50 cfm m <sup>3</sup> /h (50 cfm)
Float box:	Single chamber with positive sealing air separation. Stainless steel float ball and linkage
Discharge Check Valve:	Swing Style – ductile iron with Buna-n Disc

## ENGINE

**CERTIFIED  
STAGE V**



Brand	VOLVO
Model	TAD581VE
Gross Power	129 kW @ 2300 rev/min
Displacement	5,13 l.
N° cylinders	4
Cooling system	Water cooled
Exhaust emission	Stage V

## CONTROL PANEL

Controller model NT5 by Nettuno



- Auto start/stop system
- Switch manual – 0 – Automatic
- Tachometer
- Hour counter
- Warning lights “oil and engine temperature”
- Warning light “auto stand-by”
- GPRS – VISA Web supervisor & APP
- Geolocation and Geo-fencing
- Soot / Ash filter control
- Two float switches (min/max level) support for automatic operation

The data contained in this document is nominal and refers to the standard equipped model and is not binding. Visa S.p.A. reserves the right to revise the information without notice.

**ONIS VISA Zeus Dry Prime****Model: MTZ.V175.SS****MULTI-SPEED PERFORMANCE CURVE**

**World-class performance:** Using high efficiency pumps and top performance diesel engines, the Zeus Dry Prime units offer high performance and efficiency to ensure predictable and timely job completion with minimal operating expenses

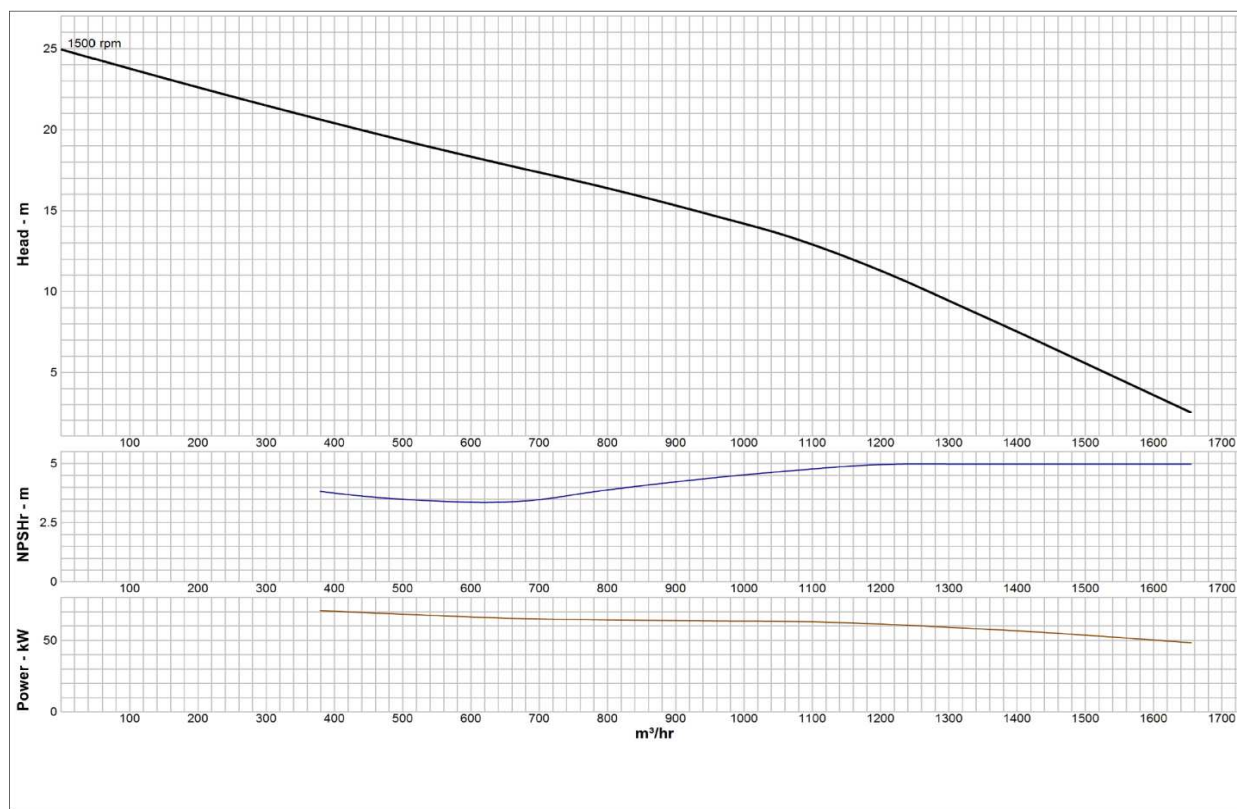

The data contained in this document is nominal and refers to the standard equipped model and is not binding. Visa S.p.A. reserves the right to revise the information without notice.

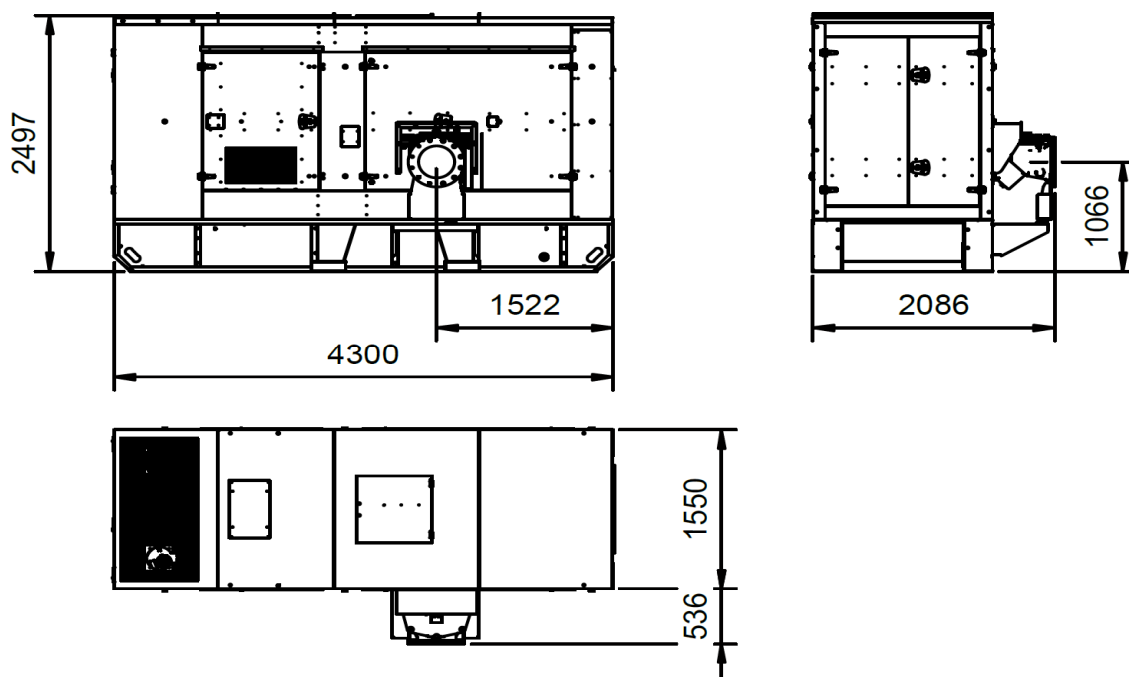
**PRELIMINARY DIMENSIONS**

**Nettuno motorpumps designed & built by VISA SPA • Complete in-house design & production**

- Over 45 years of experience in the motorpumps sector
- In-house extensive testing facility
- Modern & functional design
- Durable materials
- Customizations available

The data contained in this document is nominal and refers to the standard equipped model and is not binding. Visa S.p.A. reserves the right to revise the information without notice.