

ONIS VISA Zeus Dry Prime

Model: MTZ.P82.SS

MODEL: Dewatering



ALL PICTURES SHOWN ARE FOR ILLUSTRATION PURPOSE ONLY

MAIN DATA

Max. flow	540 m³/hour
Max. Max head	33 mwc
Solids handling	76 mm
Suction connection	DN150 PN16
Delivery connection	ANSI 6"
Fuel tank	200 l.

DIMENSIONS AND WEIGHT

Width	1185 mm
Length	2457 mm
Height	1787 mm
Weight	1600 Kg (approx)

The **Zeus Dry Prime** range delivers fast dewatering solutions to sites where a power source is not available. Using a Pioneer pump featuring a 100% mechanical priming system, the Zeus Dry Prime motorpumps quickly prime and reprime, even from dry conditions.

PUMP



Brand Pioneer

Model PP66S10T E0 410

Pump casing: 65-42-12 ductile iron with 280 BHN hardness

Enclosed impeller: CA6NM Self-hardening Stainless Steel with 13% chromium with 360BHN hardness

Pump shaft: 1144 Stress Proof Steel Chromed

Bearings: Dual angular contact drive end bearings

Priming system: Mechanically Driven Diaphragm Style vacuum pump

Air removal capab.: 85 m³/h (50 cfm)

Float box: Single chamber with positive sealing air separation. Stainless steel float ball and linkage

Discharge Check Valve: Swing Style – ductile iron with Buna-n Disc

ENGINE



Brand PERKINS

Model 1104D-44T

Gross Power 60 kW @ 2200 rev/min

Displacement 4,4 l.

N° cylinders 4

Cooling system Water cooled

Exhaust emission Stage IIIA

CONTROL PANEL

Controller model NT5 by Nettuno



Auto start/stop system

Switch manual – 0 – Automatic

Tachometer

Hour counter

Warning lights “oil and engine temperature”

Warning light “auto stand-by”

GPRS – VISA Web supervisor & APP

Geolocation and Geo-fencing

Soot / Ash filter control

Two float switches (min/max level) support for automatic operation

The data contained in this document is nominal and refers to the standard equipped model and is not binding. Visa S.p.A. reserves the right to revise the information without notice.



ONIS VISA Zeus Dry Prime

Model: MTZ.P82.SS

MULTI-SPEED PERFORMANCE CURVE

World-class performance: Using high efficiency pumps and top performance diesel engines, the Zeus Dry Prime units offer high performance and efficiency to ensure predictable and timely job completion with minimal operating expenses

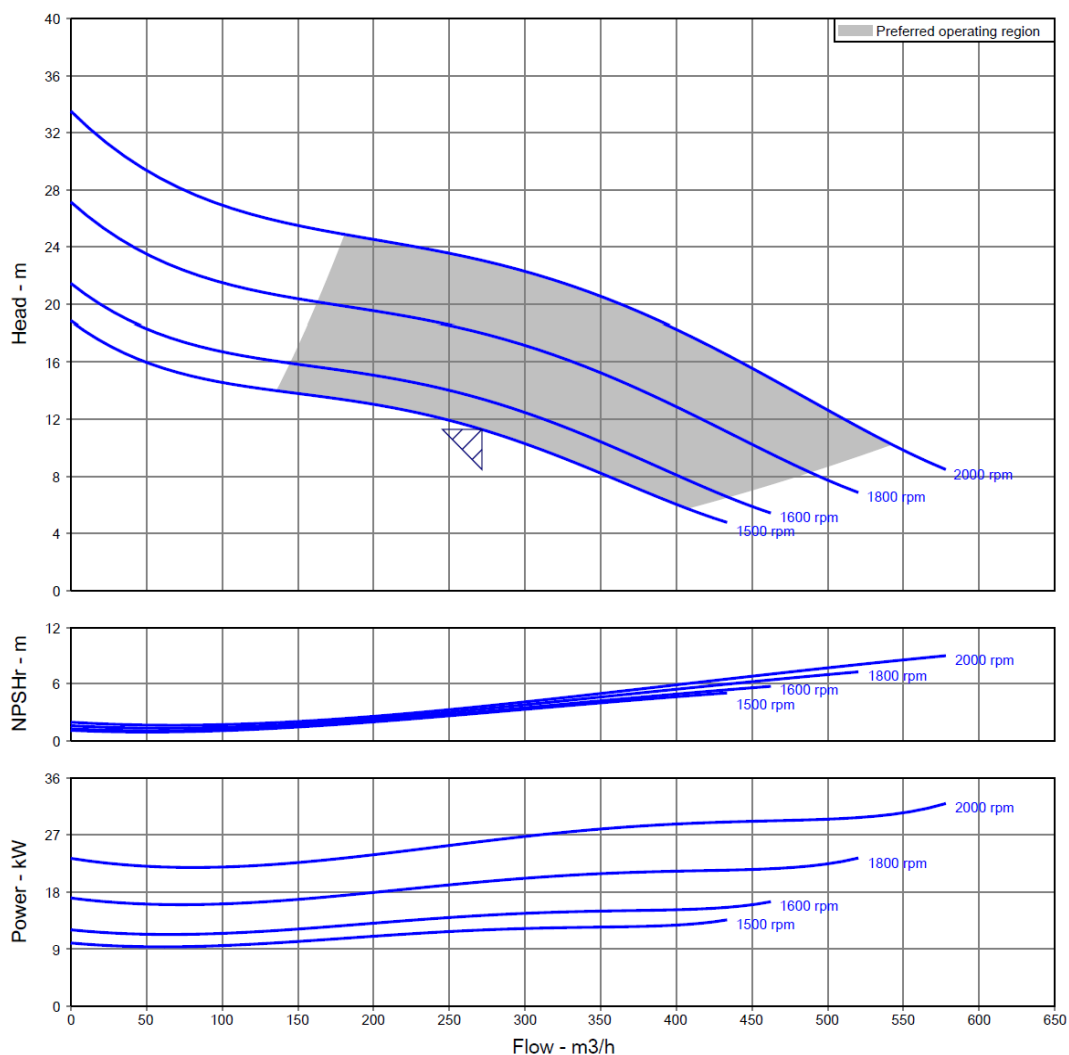

Description	: PP66S10	Speed, rated	: 1500 rpm
Stages	: 1	Based on curve number	: 66S10
Differential head / pressure, rated	: 11.28 m	Efficiency	: 69.34 %
Fluid density, rated / max	: 0.998 / 0.998 kg/dm³	Viscosity	: 1.00 cSt
Power, rated	: 12.01 kW	Cq/Ch/Ce/Cn [ANSI/HI 9.6.7-2010]	: 1.00 / 1.00 / 1.00 / 1.00
NPSH required	: 2.91 m	Impeller diameter, rated	: 241 mm
		Saved Date	: 20 Jan 2022 3:25 AM

The data contained in this document is nominal and refers to the standard equipped model and is not binding. Visa S.p.A. reserves the right to revise the information without notice.

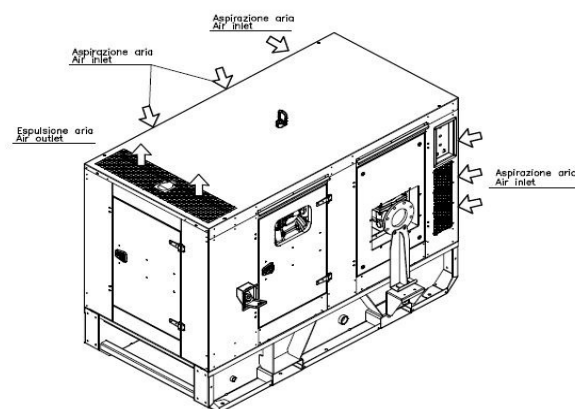
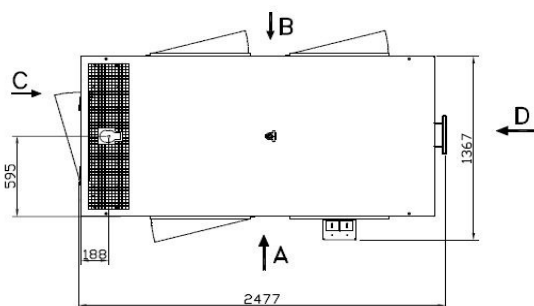
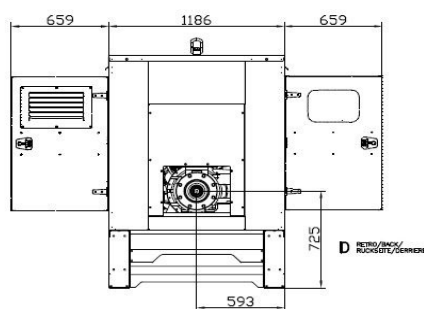
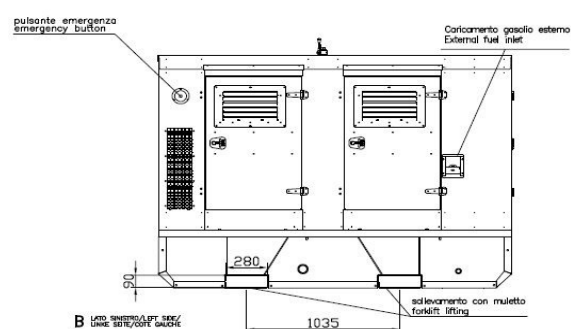
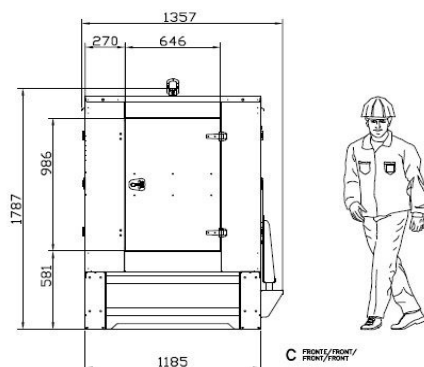
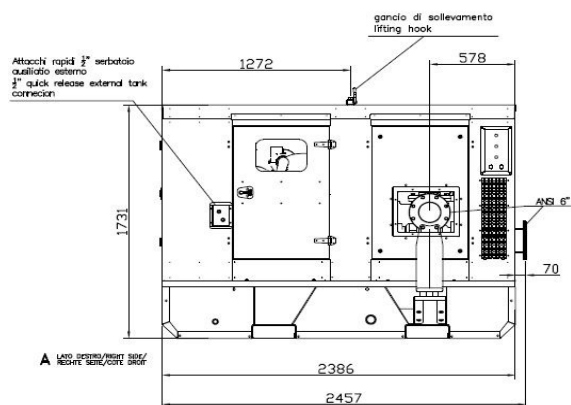
PRELIMINARY DIMENSIONS

Nettuno motorpumps designed & built by VISA SPA • Complete in-house design & production

- Over 45 years of experience in the motorpumps sector
- In-house extensive testing facility
- Modern & functional design
- Durable materials
- Customizations available

The data contained in this document is nominal and refers to the standard equipped model and is not binding. Visa S.p.A. reserves the right to revise the information without notice.